

the G series

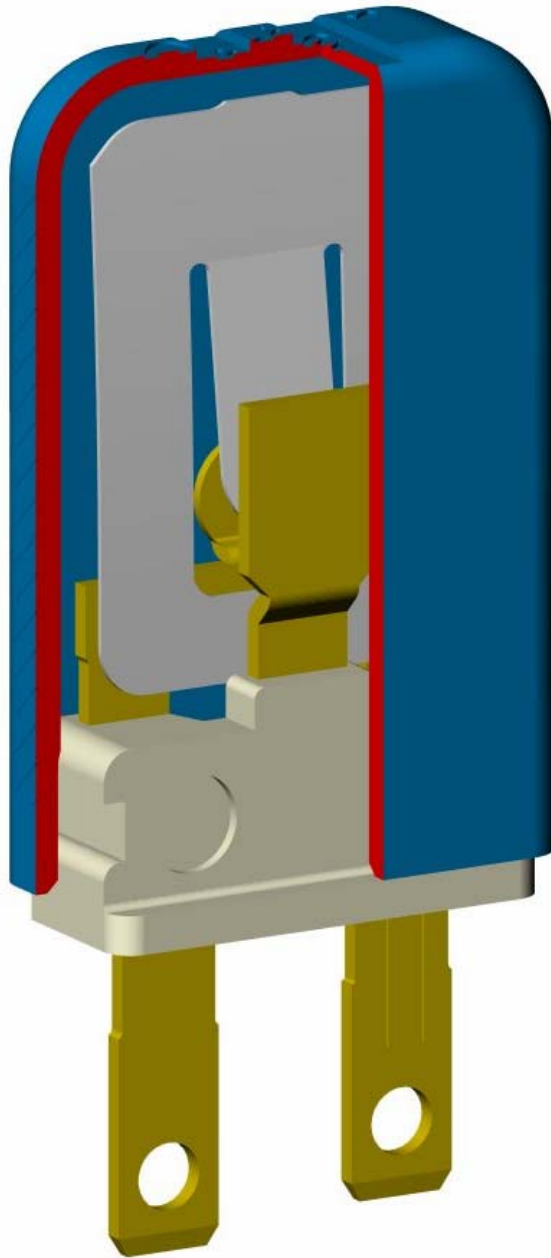

motor protector, thermal safety
cut-out and thermostat

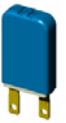

G5/G6/G7 series design



This widely used versatile snap-action auto reset protector offers an extensive range of cover options to accommodate different fixing, heat transfer and environmental conditions. Excellent thermal response can be combined with a wide spectrum of current sensitivity to give optimum protection in any specific situation. The G6/G7 is supplied with terminals to suit both welding and soldering and a version with leads and optional seal against ingress of varnish is also available.

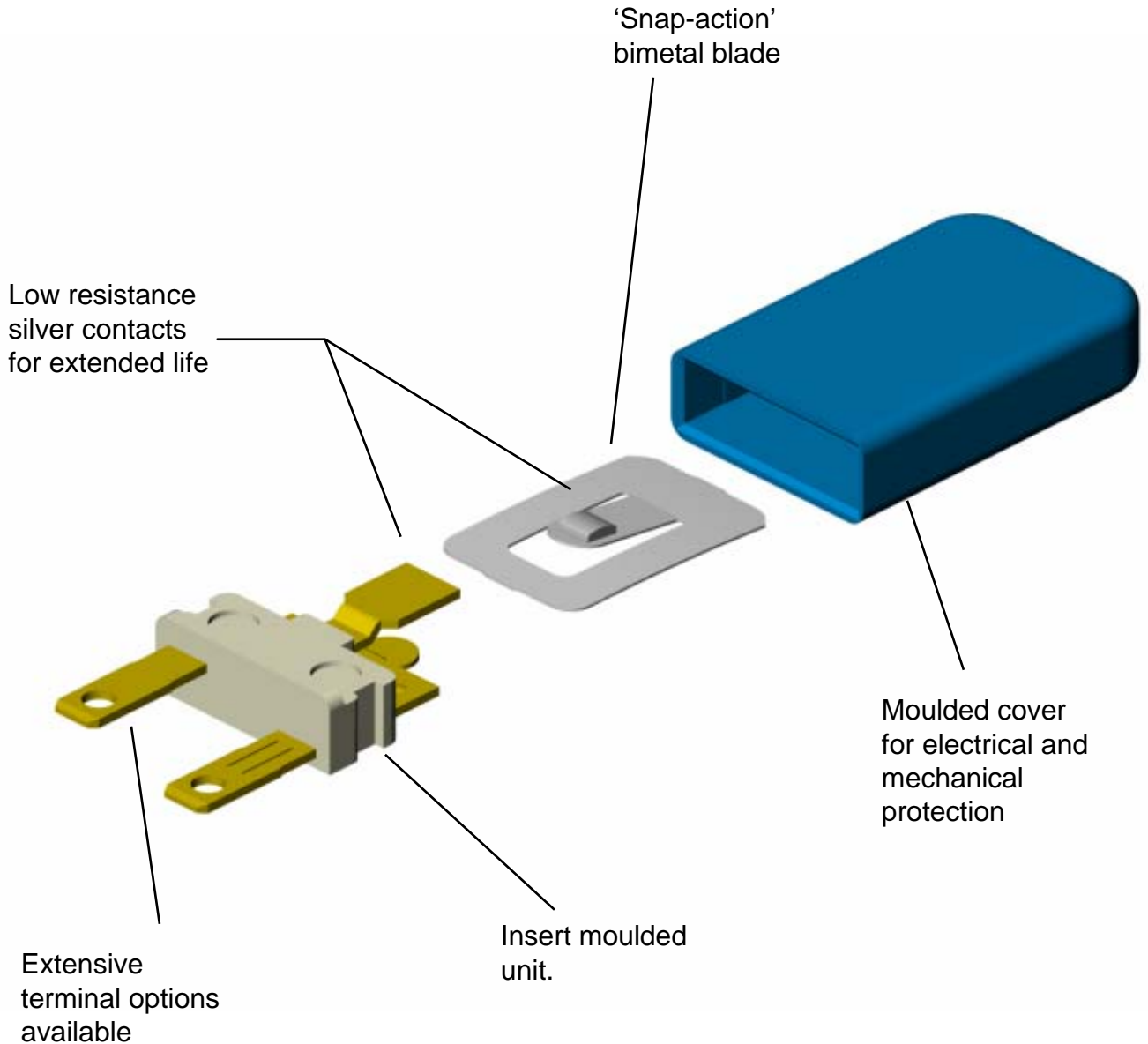

The 'G' series offers a full range of current and temperature sensitive combinations to give optimum protection.



G5/G6/G7 series in operation



G contacts closed

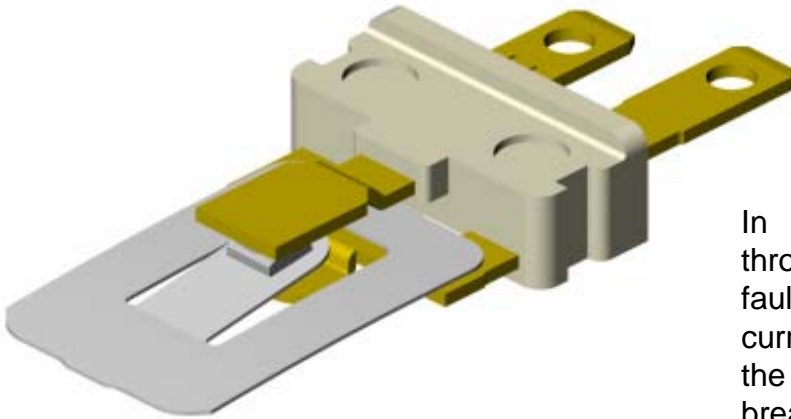

In normal operation current flows through the bimetal blade. When a fault condition occurs, the increased current flow through the blade raises the temperature, which snaps open breaking the circuit.

G contacts open

Circuit is broken, allowing motor winding temperature to cool to a safe level before the blade snaps back and the contacts close.

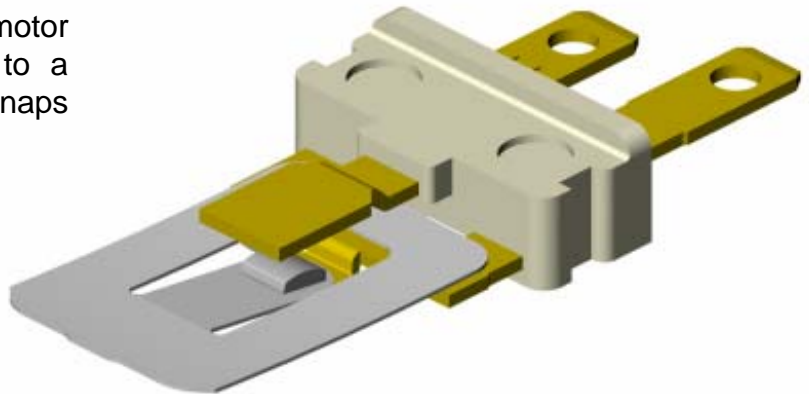

Note:

Other terms used to describe motor protectors include, Bimetal cut-out, trips, thermo-trip, circuit breaker, switch, over current protector, etc



G series engineering specification



The following data gives a brief overview of the specification/capabilities of the G series.

1. Normal operating voltage: 12V: (9 - 15V)
24V: (18 – 30V)
2. Rated switching current: 12V: 3 - 100A
24V: 2 - 15A
3. Operating ambient temperature range: - 40 to +80°C
4. Operating characteristics at 20±3°C: See. T/C curves over page for full operating range.
Continuously rated current up to 15Amps.
5. Remake characteristics: Cut-out: above 30°C
Thermostat: above 1°C
6. Voltage drop: max 200mV
7. Insulation resistance: 1MΩ min. at 500V
8. Terminal materials: G6 – Brass CZ108
(63% Cu, Rem Zn)

G7 – Nickel Silver NS107
(55% Cu, 18% Ni, Rem Zn)
9. Unit material: NYLON 66
(Latamid 66 H2 G/25-V0 CT1)
10. Cover material: 30% Glass filled PA66
(Technyl A216 V30)
11. Contact material: 99.9% Ag (Surface)
CuNi30Fe (Backing)
12. Endurance: **AC:** 13(5) Amps at 240V 50Hz
for 3000 cycles
AC: 5 Amps at 240Volts 50Hz
for 30000 cycles
DC: 11 Amps at 24Volts for
10000 cycles
DC: Rated current at 12Volts
for 35000 cycles

Material content IMDS data is held at www.mdssystem.com. Please contact imds@ottercontrols.com for details.



OTTER CONTROLS LIMITED, HARDWICK SQUARE SOUTH, BUXTON, DERBYSHIRE, SK17 6LA, UK

Tel: +44 (0) 1298 762300 Fax: +44 (0) 1298 72664

www.ottercontrols.com e-mail: sales@ottercontrols.com

Page - 3

Issue 2 -
23/04/2003



G series operating range

G series performance range @ 20°C

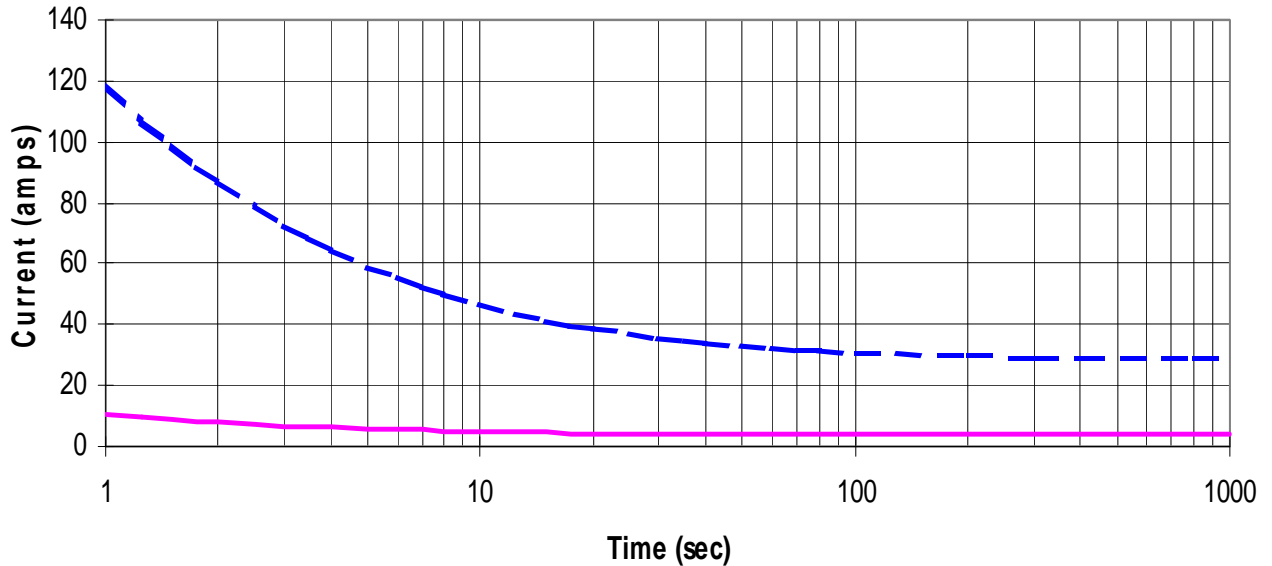

G series package size

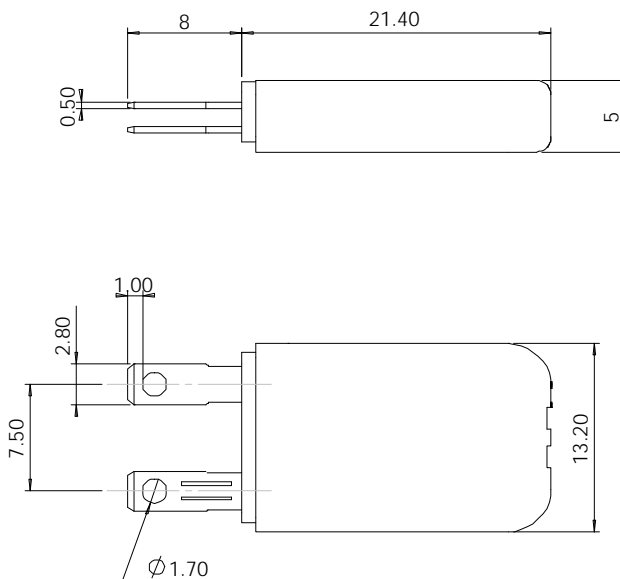



G5/G6/G7 series nomenclature

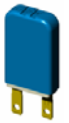

G series nomenclature

1	2	3	4	5	6		7	8	9	10
Switch Range	Unit Type	Cover Type	Bimetal Grade	Bimetal	Terminal Arrangement †		Special Additions	Setting Method	Checking Instructions	Bimetal Feature
					Terminal 1	Terminal 2				
G	1 Manual Reset	* Transit cover	B		0 No crop, no fold	No crop, no fold	+ Terminal clip	C Cabinet	0 No instructions	. 0.006" thick
	2 Automatic reset	0 No cover	C		1 V crop, no fold	V crop, no fold	0 No addition	T T/C set	C T/C check, special ident	7 0.007" thick
	5 Min contact gap	1 Side fixing lugs, end fixing lug, manual reset	F		B No crop, 90° fold	No crop, 90° fold	2 Terminal leads	0 Oil set	L Special ident	
	6 As 9 with terminal holes	2 Terminal rear covered, side fixing lugs, vent hole on	J		C Convolute terminal tubing	Convolute terminal tubing	3 Terminal leads		T T/C check	
	7 Unit with Nickel Silver terminals	3 As 1 but larger reset button and uncovered terminals	K		G V crop, 23° fold	V crop, -23° fold	5 Terminal solder dip			
	9 Unit with brass terminals	4 Terminal rear covered, vent hole on top side	L		J No crop, -90° fold	No crop, -55° fold	C Hot terminal markings			
	A As 7 with terminal holes	5 Internal pips	P		L No crop, no fold	No crop, detail fold	D Terminal braid			
		7 Hole with flat on top side	U		Q No crop, 90° fold	No crop, 90° fold	H Ident '85' on terminal			
		9 As 7 with hole on underside			R No crop, 90° fold	No crop, 90° fold	J Terminal braid			
		B Vertical side click			W V crop, 30° fold	V crop, 45° fold	L Leads			
		C Side fixing lugs, terminal rear covered, hole with rib in			X V crop, -14° fold	V crop, -45° fold	R Terminal peg			
		D As 2 with hole with flat on top side			Y Straight crop, no fold	Straight crop, no fold	S Leads			
		E Terminal rear covered, guide slot on inside			Z V crop, no fold	V crop, no fold	T Hot terminal markings			
		H As 4 with half moon slot					Z Greased contacts			
		J Horizontal side click (cold terminal), internal pips								
		K Vented both sides								
		L Terminals covered, larger fixing lugs								
		M Horizontal side click (hot terminal)								
		W Terminals covered								



G5/G6/G7 terminal variations

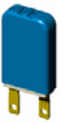

The G series can be produced with a range of folded and cropped terminal options. Contact Sales Office to confirm availability.

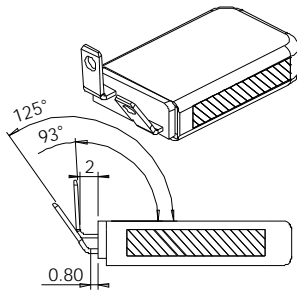

G-5-J0

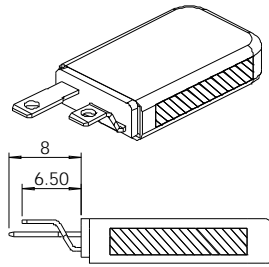

G-5-L0

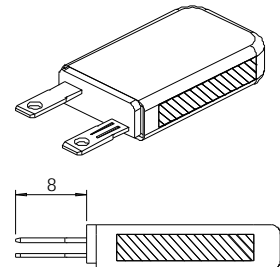

G-5-00

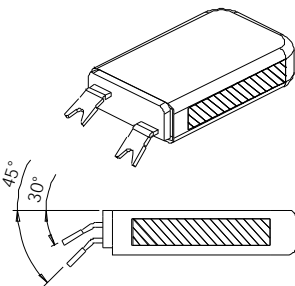

G-5-W0

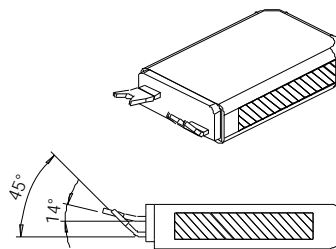

G-5-X0

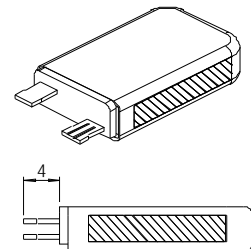

G-5-YT

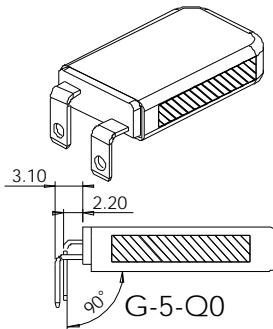

G-5-Q0

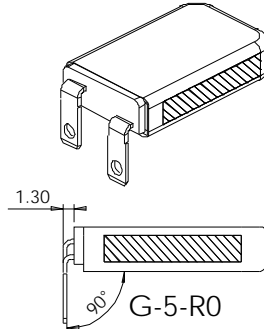

G-5-R0

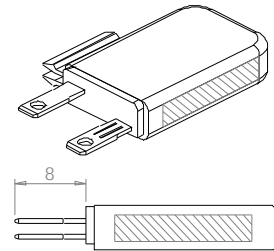

G-J-00

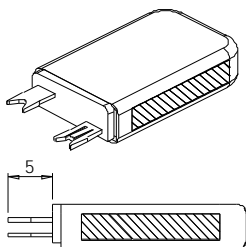

G-5-Z0

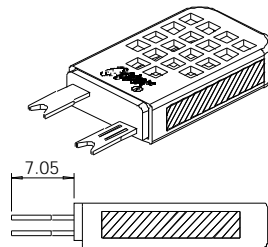

G-K-10

Contact the Sales Office for detailed drawings.



global representation

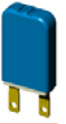

When contacting an Otter overseas representative, use international access code before number shown.

Australia M & D CONTROLS, PO Box 53, Kilsyth, Victoria 3137.
Tel/Fax: 61 3 9735 1749

Denmark CHEMO-ELECTRIC AS, Hammerholmen 39, DK-2650 Hvidovre.
E-mail: info@chemolec.dk
Tel: 45 36 773044 Fax: 45 36 773088

Finland EL-FRESTA OY AB, Ilmeentie 3, FIN-02140 Espoo.
E-mail: yrjo.vasenius@elfresta.fi
Tel: 358 9 547 66500 Fax: 358 9 547 66510

France/Italy SICCOM SA, Z.I. Les Bordes 2 - 6 rue Gustave Madiot 91922 BONDOUFLE CEDEX.
E-mail: commercial@siccom.fr
Tel: 331 6086 8798 Fax: 331 6086 8757

Germany/Austria/Switzerland ROGELEIN GmbH, Postfach 10 40 32, D-70035 Stuttgart.
E-mail: dieter.roegelein@roegelein.de
Tel: 49 711 187790 Fax: 49 711 1877910

Hong Kong/China/Taiwan OTTER CONTROLS ASIA LTD, Unit C,D, 14/F Spectrum Tower, 53 Hung To Rd, Kwun Tong, Kowloon
E-mail: angela@otterasia.com
Tel: 852 2 1913303 Fax: 52 2 1746992

India AURO CONTROLS PVT LTD, Florina Apartment, 6th Floor,, S. No. 2/1/7, Erandwane, Off Karve Road,, Pune - 411 004 , Maharashtra , India,
E-mail: neesh@aurocontrols.com
Tel: 91 20 433 4254/8173 Fax: 91 20 433 8173

Israel ELECTRIC INDUSTRIES LTD, PO Box 6560, Tel Aviv 61064.
E-mail: eindust@attglobal.net
Tel: 972 3 6046634 Fax: 972 3 5467452

Japan AOYAMA SPECIAL STEEL Co. Ltd 9-11, 2-Chome, Shinkawa, Chuo-Ku, Tokyo
E-mail: sales@aoyamasteel.co.jp
Tel: 81 3355 25255 Fax: 81 3 3553 1270

Korea YUHAN ACS, Room #819 Samil- Plaza Bldg, 837-26, Yeoksam-Dong, Kangnam-Ku, Seoul.

E-mail: mocom@yuhanacs.com
Tel: 82 2 555 6525 Fax: 82 2 555 4705

Malaysia TEAMTECH SDN BHD, No 12, TIB-1/2 Taman Industri Bolton, 68100 Batu Caves, Selangor Darul Ehsan. Tel: 60 3 61881228
Fax: 60 3 61889228

Norway HILLCO AGENTURER AS, Post Box 11, Leirdal, 1008 Oslo.

E-mail: halto@online.com
Tel: 47 23 17 52 80 Fax: 47 23 17 52 81

Poland TESKO, J Cybsa 8/37, PL-02-784 Warsaw.
Tel: 48 22 641 6282 Fax: 48 22 641 6282

Russia JOINT CONSULTING TRADING LTD, bld.1/2, 11, Ordzhonikidze street, 15419, Moscow, Russia.

E-mail: yuri@irca.ru
Tel: 7 (095) 2324187 Fax: 7 (095) 2324189

Spain DULLAC IMPORT-EXPORT, c/Roure Gros 29, Pol. Ind. Mas d'en Cisa, 08181 Sentmnat

E-mail: gdejuan@dullac.com
Tel: 34 93 715 45 17 Fax: 34 93 715 45 39

Sweden Promoco AB, Box 273, S184 24 Vallentuna
E-mail: sec@promoco.se

Tel: 46 8 792 9151 Fax: 46 8 792 2090

USA DAVIDON INDUSTRIES INC, 205 Hallene Road, Unit 317C, Warwick Rhode Island 02886,

E-mail: ddinuccio@davidonindustries.com
Tel: 401 737 8380 Fax: 401 737 8395

Important Note:

The information contained within this Document is subject to Otter Terms and Conditions of Sale.



OTTER CONTROLS LIMITED, HARDWICK SQUARE SOUTH, BUXTON, DERBYSHIRE, SK17 6LA, UK

Tel: +44 (0) 1298 762300 Fax: +44 (0) 1298 72664

www.ottercontrols.com

e-mail: sales@ottercontrols.com

Page - 7

Issue 2 -
23/04/2003